

HunterDouglas Awards

# ARCHI PRIX

AMSTERDAM 2001 • ISTANBUL 2003 • GLASGOW 2005 • SHANGHAI 2007 • MONTEVIDEO 2009 • CAMBRIDGE USA 2011 • MOSCOW 2013 • MADRID 2015

WORLD'S BEST GRADUATION PROJECTS

## AHMEDABAD 2017

दुनिया की सबसे अच्छी स्नातक परियोजनाएँ

ARCHITECTURE  
LANDSCAPE ARCHITECTURE  
URBAN DESIGN

CEPT  
UNIVERSITY

ARCHI  
PRIX



NAI010 PUBLISHERS

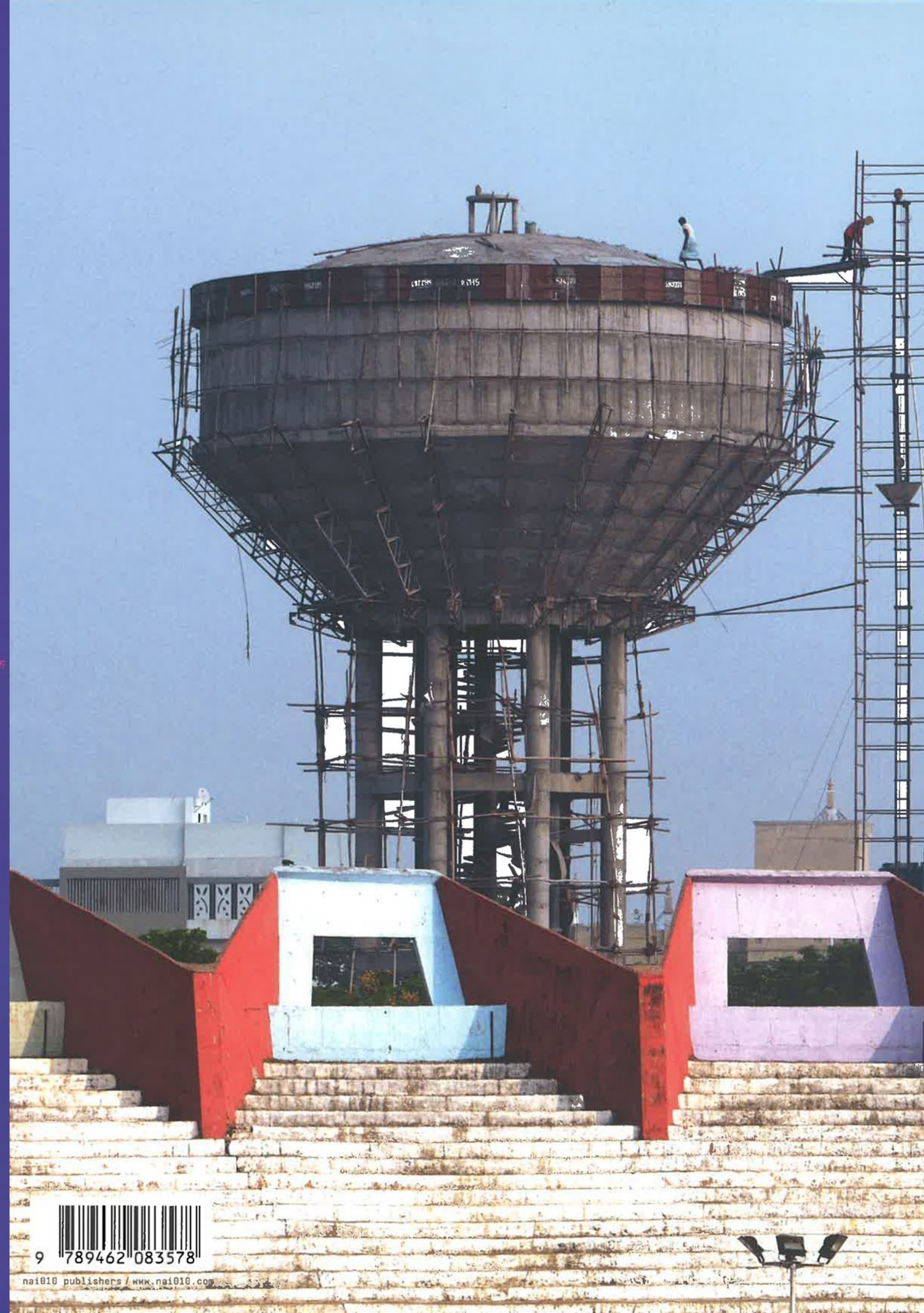

nai010 publishers / www.nai010.com

ARCHIPRIX AHMEDABAD | WORLD'S BEST GRADUATION PROJECTS • 28

## SMART NETWORK FOR ALBANIAN POST-INDUSTRIAL LANDSCAPE

Powerplant reconversion

Tutors > A.B. Menghini, M. Beccu, F. Calace, R. Belli, F. Pashako / Discipline > Landscape Design  
PROJECT LOCATION > ALBANIA, FIER

designed by > Vito Quadrato, Massimiliano Cafagna, Silvia De Mauro,  
Pierluigi Ruggeri, Alberto Pice, Daniele Fiore

POLITECNICO DI BARI, I FACOLTÀ DI INGEGNERIA, DIPARTIMENTO URBANISTICA ED ARCHITETTURA,  
COURSE OF BUILDING ENGINEERING AND ARCHITECTURE

EUROPE - ITALY - BARI

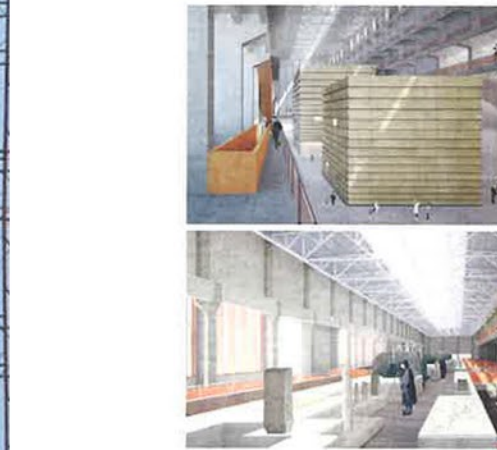

Cross section and floorplan



Elevation



Post industrial landscape



Interior view



After the fall of the socialist regime in 1990, Albania is now undergoing a strong period of economic growth. For the Albanian government, the time has come to develop strategies which target large abandoned industrial heritage, characterized by high architectural quality. This was created thanks to Soviet and Chinese structural technologies, which ensured these buildings of a long life. The purpose of the thesis is to research the conversion of the most important former thermo-electric powerplant in the country (T.E.C., 1966), located in the neighbourhood of Fier. Through a typological study of industrial ruins, we distinguished between 'big industrial containing objects', and 'small industrial contained objects'. We identified modular relationships and dimensional consonances between the group of buildings. **The project has two main goals: transforming the exterior ground surface from an industrial and functionalist space into a public space while converting the interior into a culturally oriented space.** This will create a positive dialogue between the existing industrial machines (turbines and boilers) and the new elements of the project. This cultural and interactive space, placed in the suggestive engine room of T.E.C. 1966, consists of co-working laboratories, a great museum, didactic areas and a conference hall, and recomposes the relationship between regional inhabitants and the memory of their territory full of traditions. The exterior design resolves the conflict that exists between natural elements and the factory through the projection of green plots, which bring into the public space different aspects of the Albanian landscape, characterized by lagoons and farms.